

Switching system heating/cooling



- Please read the steps below before you start setting up.
- If no key is pressed for a few seconds, the screen will return to the initial mode

Step 1:

Click once on the middle round button so that the display lights up and the 'sun' becomes visible.

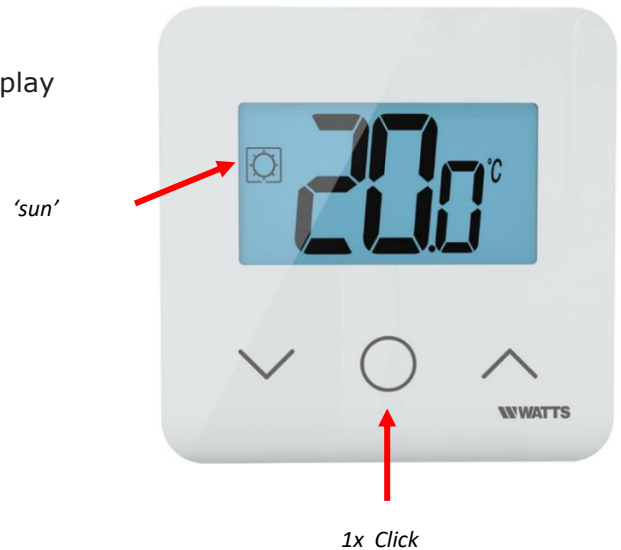

Step 2:

Press and hold the middle round button for 3 seconds until the square around the sun flashes.

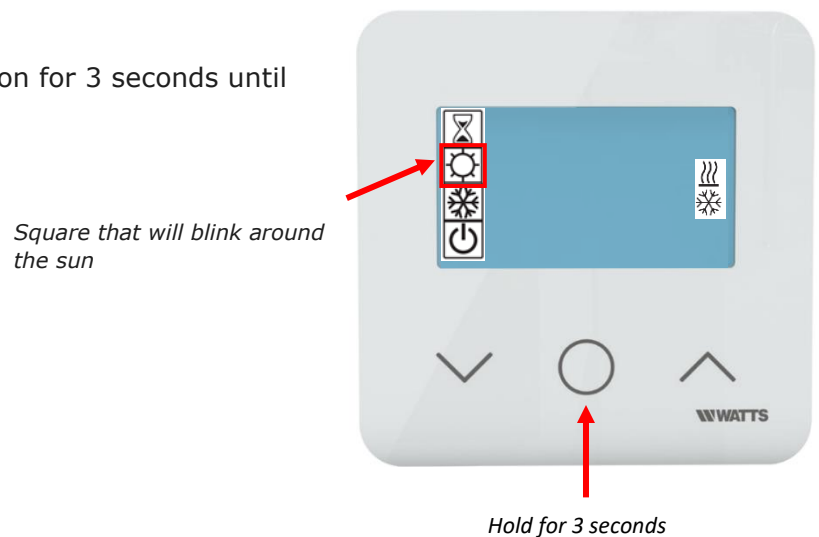

Step 3:

Now use the left arrow key to move the square from the 'sun' to the 'heating/cooling symbol' on the right side, which will flash.

Press the middle round button when the square is around the heating/cooling symbol.

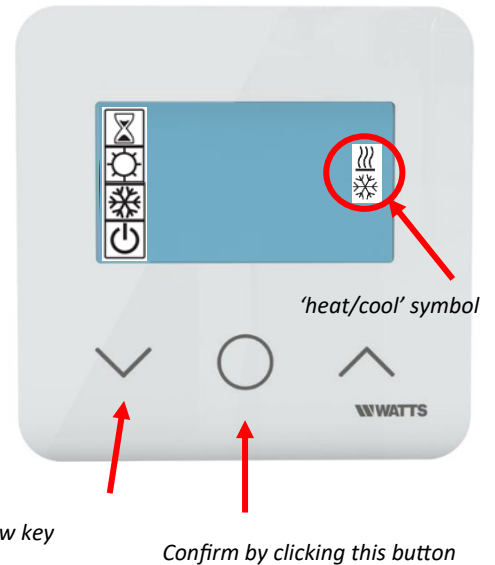

Step 4:

Now press the left arrow key to choose between 'Hot' and 'CLD'

- 'Hot' 
- 'CLD' 

Confirm this by clicking on the middle round button

